

SPRAGUE FACT SHEET

HISTORY

- In 1914, the Sprague Branch opened at its previous location, 1035 East 2100 South.
- This English Tudor-style building opened in 1928, and was constructed for \$36,000.
- Named for Joanna Sprague, the Salt Lake City Public Library System's Executive Director from 1903–1940.
- Built by Paulsen Construction, which was founded in 1925 and still operated by the Paulsen family.
- The American Library Association named Sprague the "Most Beautiful Branch Library in America" in 1935.

THINGS TO SEE

1. Welcome to the Sprague Branch! The interior space is 13,058 square feet, and the current collection has 23,000 items.
2. Notice how the design team intentionally recreated the English Tudor-style building on the first floor.
3. Be on the lookout for sugar beets and other Sugar House landmarks throughout the building:
 - *Snelgrove Ice Cream Cone*
 - *Nu-Crisp Popcorn*
 - *Monument Square*
 - *Granite Furniture "Sputnik"*
 - *Sugar House Costume Company*
 - *Stark Steering*
4. Stop by the Creative Lab, where you can learn, make, craft, and explore new technologies.
5. Take a moment to play with the Everbright light wall near the Creative Lab.
6. Stay awhile! Shade structures make the outdoor space more comfortable. You can lounge on the outdoor furniture during warmer months.

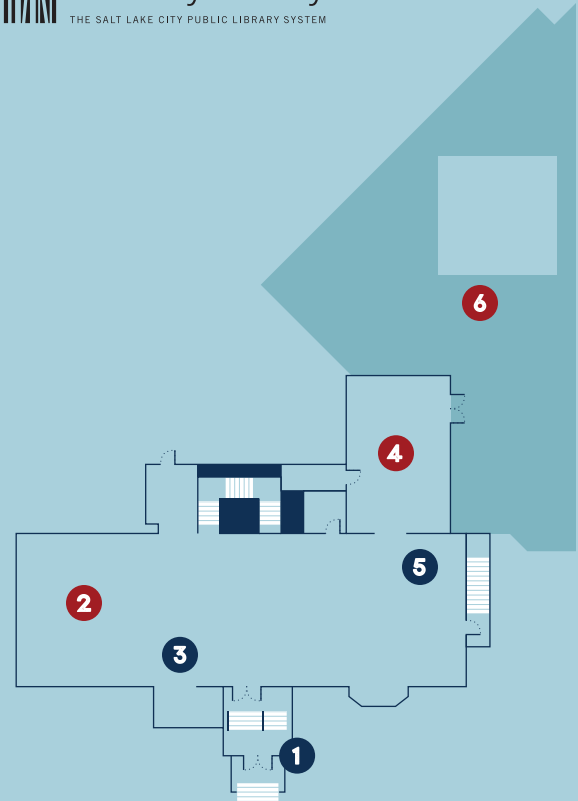

GROUND LEVEL

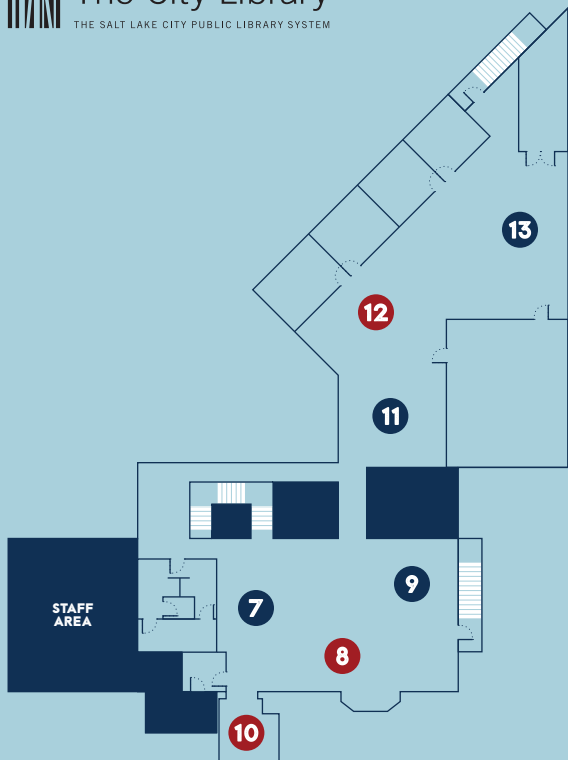

BASEMENT

RENOVATION INFORMATION

- On July 26, 2017, a flash flood filled the lower floor of the Sprague Branch with 5.5 feet of water.
- Planning and design for the renovation began in 2018.
- Physical renovations began in April 2019, continuing throughout COVID, with a slight delay to meet heightened safety needs of the construction crew during the pandemic.
- Renovation was completed in April 2021, with a total budget of \$4.5 million.
- Architectural teams Arch Nexus and Margaret Sullivan Studio joined forces with Paulsen Construction and subcontractors to design and remodel the Sprague Branch.
- The design team incorporated many elements to prevent the possibility of future floods, including paying special attention to the east stairs and doors, which were susceptible to flooding prior to renovation.

THINGS TO SEE

7. Enjoy the new seating and space to play in the Children's Room.
8. Judge a book by its cover! Many of the children's books face outward, making it easier for young readers to browse.
9. Look up at the ceiling in the Children's Room and see how many different animal friends you can spot.
10. Don't miss the Moss Wall in the Tween Space!
11. Take a peek inside the plant terrarium in the Teen Room.
12. Get some work done with the Business Incubator, which has four study rooms and a larger meeting room with a retractable glass wall.
13. Check out the large LED laylight above the public computers that provide patrons with a natural light feel, no matter the time of day!